

ADVENTURE



**MADE
FOR
HERE**



MADE FOR HERE

Jayco Crosstrak 16.48-5

Jayco 48V Adventurer 19.61-2

Jayco Crosstrak 17.51-5

For over 50 years, more Australians have hit the road with one name they know they can rely on — Jayco. Built with experience, backed nationwide, and trusted across generations of travellers.

BUILT IN AUSTRALIA

Built by local experts using quality parts from trusted suppliers.

VALUE FOR MONEY

283,000+ RVs built with features others only offer as upgrades.

RE-SALE VALUE

A smart long-term investment that holds its value over time.

SUPPORT NETWORK

Over 130 service agents ready to help across Australia & New Zealand.

TRADE-IN CONFIDENCE

We back our product — you can always trade in your Jayco when you're ready.

PARTS & ACCESSORIES

Easy access to parts, servicing, and upgrades right across Australia.



WHEREVER YOUR 'HERE' IS

Whether it's the pull of the coastline, the calm of a quiet forest, or the simple joy of the open road, a Jayco is made for the moments that matter most.

Made for Australian conditions. Made for confidence when the road stretches on. And made to feel like home, wherever you pull up for the night. From livable layouts and quality craftsmanship to practical features that make every journey easier, Jayco caravans are designed to help you travel your way —

comfortably, reliably, and without compromise. Because adventure looks different for everyone. And wherever yours takes you, it helps to know your caravan was built for it.

**IT'S TIME TO HIT THE ROAD
IN A JAYCO!**



CROSSTRAK

HYBRID POP TOP

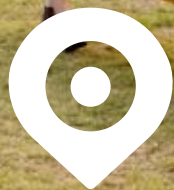

**MADE FOR
EASY ESCAPES**

Jayco Crosstrak 16.48-5



There's freedom in travelling light

Knowing your Crosstrak Pop Top Hybrid is designed with a narrower body and compact footprint, making it easier to tow, easier to manoeuvre and easier to place — from coastal roads to remote campgrounds.

Crosstrak combines genuine Jayco quality with smart, lightweight design and practical inclusions that support an outdoor-focused lifestyle. The reduced width improves visibility and control on the road, while thoughtful design simplifies setup and pack-down so you can spend more time enjoying where you've stopped.

With relaxed outdoor living features, reliable power and water systems, and the backing of Jayco's nationwide dealer and service network, Crosstrak Pop Top Hybrid delivers confidence, flexibility and long-term value — built for easy escapes and adventurous travel.



MADE FOR RELAXED TRAVEL

Comfortable Living & Sleeping

A Queen Slumberest Premium Cloud 9 mattress and a stylish leatherette seating area with lightweight aluminium framing deliver everyday comfort and support, helping you relax and recharge between adventures.

Cook Where the Day Takes You

A practical kitchen setup includes a 153L 12V dual-hinge fridge with freezer, a 2-burner internal cooktop, and a slide-out external kitchen with sink — all supported by smart, space-efficient storage for life on the move.

Easy Outdoor Living & Storage





An extra-large front toolbox, rear bumper storage and a fold-out picnic table keep gear organised and accessible, while powered jockey wheel control makes setting up camp quick and effortless.

Stay Powered, Stay Exploring

A 300Ah lithium battery paired with Jayco's PM535J power system — featuring a 35amp AC charger, integrated 30amp DC/DC charging, 3000W inverter to select power points and Bluetooth monitoring — works with twin 260W solar panels to support confident, self-sufficient travel.

CROSSTRAK HYBRID POP TOP

FLOOR PLANS

 Shower
  Refrigerator
  Wardrobe
  Optional Washing Machine

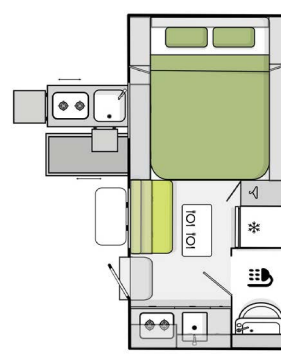



14.44-6
 Single Axle

L	6540 mm
W	2325 mm
H	2600 mm
T	2069 kg
B	216 kg

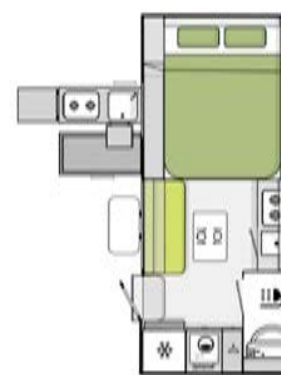



16.48-5
 Single Axle

L	7405 mm
W	2325 mm
H	2600 mm
T	2123 kg
B	184 kg





16.48-6
 Single Axle

L	7405 mm
W	2325 mm
H	2600 mm
T	2178 kg
B	190 kg

L Travel Length

W Travel Width

H Travel Height

T Tare Weight

B Towball Weight

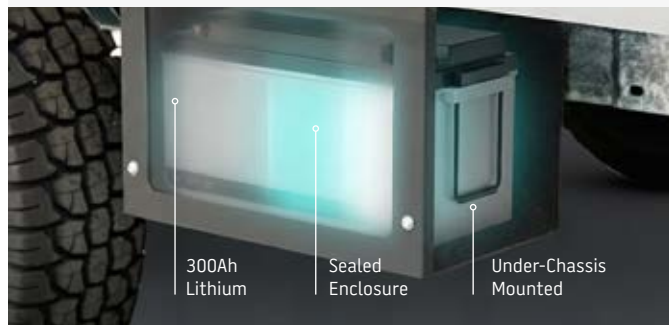

CROSSTRAK

HYBRID CARAVAN



**ADVENTURE
STARTS HERE** ←

Jayco Crosstrak 18.55-1

When your trips start to go further and your plans open up a little more, it helps to have a caravan built for adventure — not just the easy stuff.

Crosstrak Hybrid Caravan is built for travellers who want to push beyond familiar ground with confidence. Designed with added capability, practical comfort and off-grid support, it's made to handle longer stays and more flexible travel across a wide range of terrain. From upgraded power and storage solutions to a durable,

adventure-ready layout, Crosstrak Hybrid Caravan supports the way you travel — without sacrificing the control and confidence you need on the road. Built tough and backed by Jayco's nationwide dealer and service network, Crosstrak Caravan gives you the freedom to explore further, wherever your 'here' takes you.



MADE FOR COMFORT & CONVENIENCE

Recharge for the Next Leg

A Queen Slumberest Premium Cloud 9 mattress and durable leatherette seating with aluminium framing create a practical, comfortable space to unwind and recharge after full days outdoors.

Meals Made Anywhere

Internal and external cooking options make meals simple, with a large 153L fridge, internal cooktop and slide-out kitchen ready wherever you pull up.

Comfort, Wherever You Stop

A modern internal shower with exhaust fan and a roof-mounted air conditioner bring everyday comfort to life on the road, helping you stay fresh, cool and ready for whatever the conditions throw at you.

Built for Life on the Road

A 4-inch LCD touchscreen panel makes it easy to monitor vital RV systems, while bedside lights with USB ports and twin 12V fans add everyday comfort inside.



Queen size island bed with Slumberest Premium Cloud 9 Pillowtop mattress



Outdoor slide-out kitchen



Modern shower with exhaust

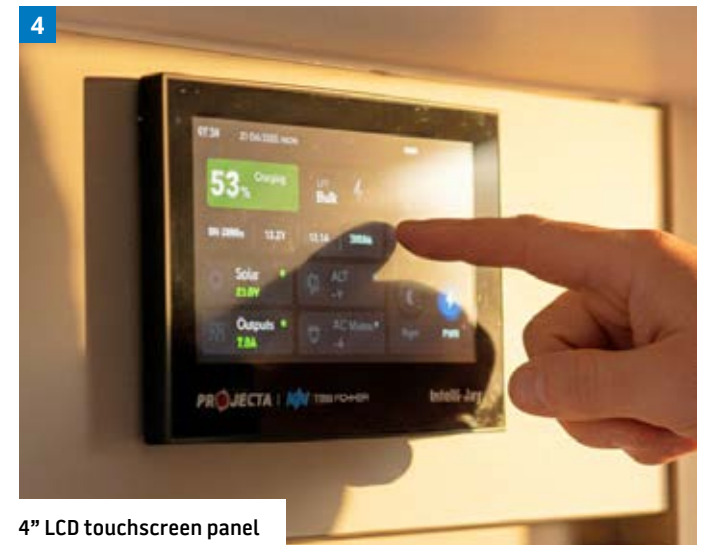

4" LCD touchscreen panel

MADE FOR ADVENTURE LIVING

1. Outdoor Living, Made Easy

A 12V electric rollout awning with integrated LED lighting creates a comfortable outdoor space, while the slide-out external kitchen with 2-burner cooktop and stainless-steel sink makes cooking outside easy.

2. Clever Storage for Real Gear

Generous storage includes a front toolbox, full tunnel boot and rear bumper storage with dual jerrycan holders, providing space for adventure gear and essentials.

3. Confident Maneuvering & Safety

A single wireless reversing camera improves visibility when parking or hitching, supported by electric brakes and Electronic Stability Control (Sway Command) for added confidence.

4. Starlink Mini Ready

An off-side 100W power socket and waterproof 12V lead allow simple plug-and-play Starlink Mini setup (device not included), helping you stay connected on the road.



CROSSTRAK HYBRID CARAVAN

FLOOR PLANS

 Shower
  Refrigerator
  Wardrobe
  Optional Washing Machine

L Travel Length W Travel Width H Travel Height T Tare Weight B Towball Weight

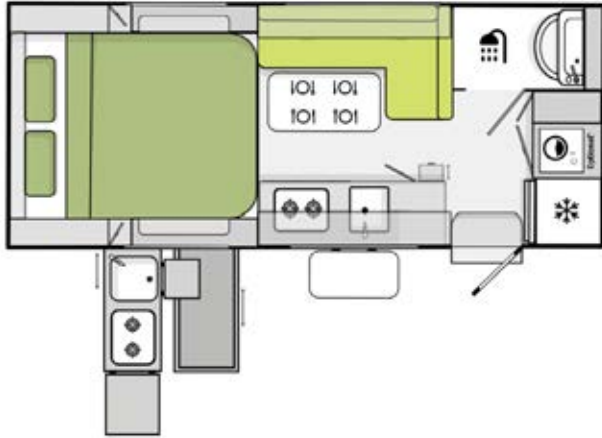

COUPLES MODEL

17.51-5
Tandem Axle



L	7855 mm
W	2325 mm
H	3135 mm
T	2526 kg
B	168 kg

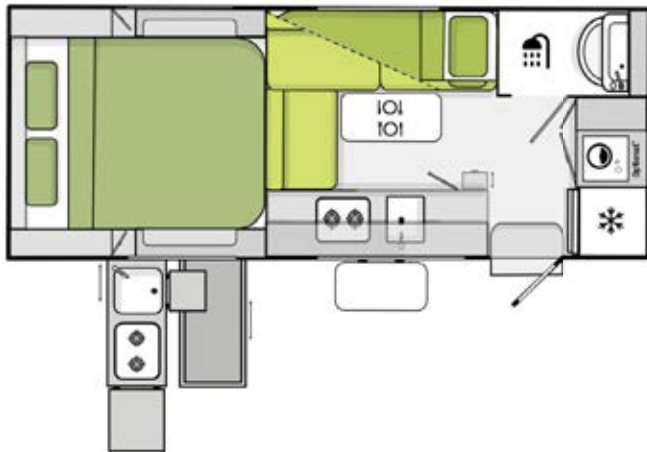

FAMILY MODEL

18.55-1
Tandem Axle



L	8120 mm
W	2325 mm
H	3135 mm
T	2580 kg
B	247 kg

The weights and dimensional data are not binding. Jayco reserves the right to alter specifications without notice. These are a guide only and will change depending on the accessories fitted to your van. It is advised to discuss this with your Jayco representative. The load carrying capacity of Jayco RVs vary from product to product to ensure it is fit-for-purpose.



MADE FOR POWERED FREEDOM

High-Capacity Solar Power

Up to 4 × 260W roof-mounted solar panels with twin-cell technology capture reliable energy to support extended stays away from powered sites.

Efficient Battery & Charging System

A 300Ah lithium battery system with integrated AC, DC/DC and MPPT solar charging efficiently manages power from solar, vehicle or mains sources.



300Ah
Lithium

Sealed
Enclosure

Under-Chassis
Mounted

48V ADVENTURER

CARAVAN

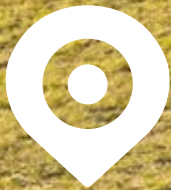

**FREEDOM
STARTS HERE** ←

Jayco 48V Adventurer 19,61-2

There's confidence in having the freedom to stay longer.

Knowing your 48V Adventurer is designed to support extended off-grid travel, deliver everyday comfort and handle changing conditions — without compromise.

Built around Jayco's advanced 48V power platform, Adventurer combines serious energy capacity with smart control. From climate control to cooking and charging, everything works seamlessly so you can focus less on logistics and more on the experience.

With rugged construction, intelligent suspension and well-considered outdoor living features, Adventurer is made for travellers who want capability without complexity — backed by Jayco's nationwide dealer and service network wherever the journey leads.



MADE FOR COMFORT & CONVENIENCE

Premium Sleeping Comfort

A queen luxury Tempur® mattress delivers exceptional support and comfort, ensuring quality rest night after night — whether you're staying put or moving on.

Modern Kitchen Design

An induction dual cooktop with convection microwave and a 224L 12V fridge with separate freezer drawer provide efficient, flexible cooking for longer stays.

Total Climate Control

FreshJet Series 7 Lite 48V roof air conditioning paired with ducted diesel heating delivers year-round comfort across changing climates.

Intuitive System Control

A 10-inch touchscreen panel provides clear monitoring of power, water levels and onboard systems, keeping everything simple and centralised.



Premium queen luxury Tempur® mattress



Induction dual cooktop



FreshJet Series 7 Lite 48V roof air conditioning



10" LCD touchscreen panel

MADE FOR CONFIDENT LIVING

1. Outdoor Living, Upgraded

A powered aluminium pull-out step, 12V electric roll out awning including LED strip light and generous lighting create a comfortable, functional outdoor space for cooking and relaxing.

2. Advanced Air Bag Suspension

JTECH AIR independent air bag suspension with integrated raiser provides a 50mm lift, improved ride control and confidence across varied terrain and conditions.

3. High-Capacity 48V Power System

A 48V electrical system with a 4000W inverter, lithium battery storage and up to 5 x 260W twin-cell solar panels delivers reliable energy for extended off-grid travel.

4. Built-In Storage & Protection

Rear bumper storage with jerry can holders, storage drawers and underbody protection ensure essential gear is secure, accessible and ready for longer adventures.



Jayco D48V Adventurer 19.61-2

2



3

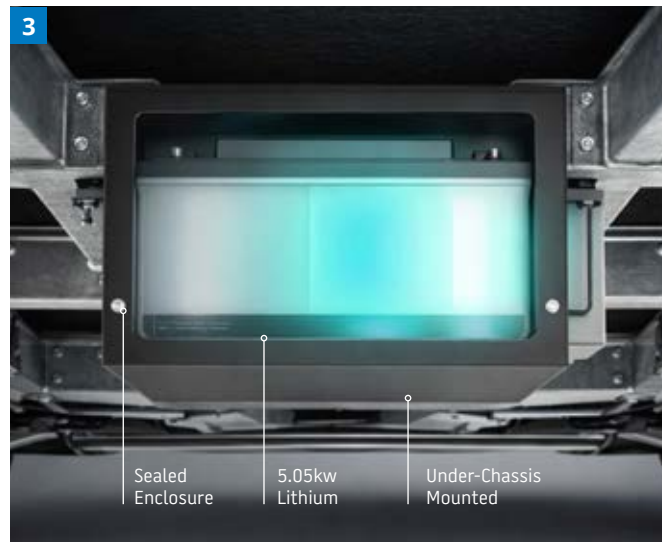

4



48V ADVENTURER CARAVAN

FLOOR PLANS

Shower * Refrigerator ☾ Wardrobe

L Travel Length

W Travel Width

H Travel Height

T Tare Weight

B Towball Weight

COUPLES MODEL

16.50-1
Tandem Axle 

L	7395 mm
W	2460 mm
H	3040 mm
T	2593 kg
B	228 kg

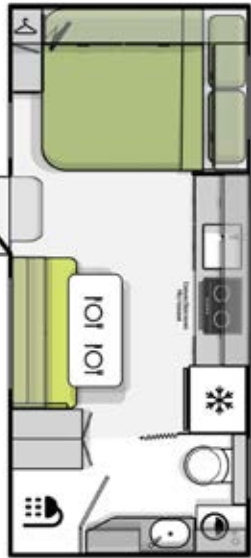

COUPLES MODEL

19.61-2
Tandem Axle 

L	8665 mm
W	2460 mm
H	3040 mm
T	2785 kg
B	235 kg

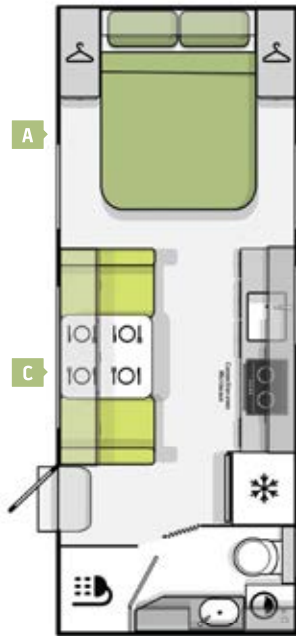

FAMILY MODEL

19.61-3
Tandem Axle 

L	8665 mm
W	2460 mm
H	3040 mm
T	2816 kg
B	224 kg



FAMILY MODEL

22.68-1
Tandem Axle 

L	9091 mm
W	2460 mm
H	3040 mm
T	2948 kg
B	271 kg

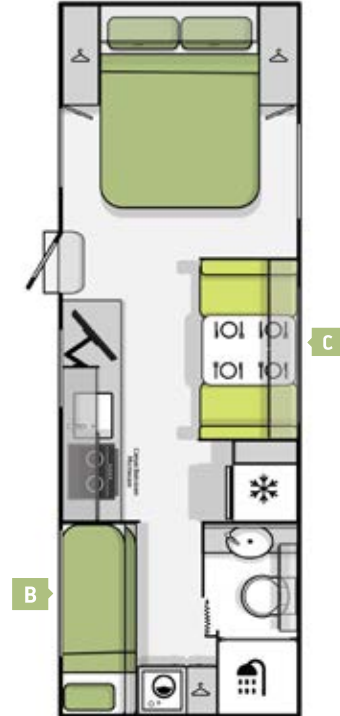

MAKE IT YOUR WAY
Optional modules available



Single beds



Triple bunks

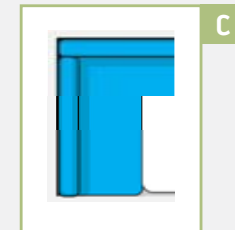

L-Shaped dinette

The weights and dimensional data are not binding. Jayco reserves the right to alter specifications without notice. These are a guide only and will change depending on the accessories fitted to your van. It is advised to discuss this with your Jayco representative. The load carrying capacity of Jayco RVs vary from product to product to ensure it is fit-for-purpose.

JAYCO ADVENTURE RANGE

FEATURES

CONSTRUCTION

	ADVENTURER 48V		
	CROSSTRAK CARAVAN		
	CROSSTRAK POP TOP		
Chassis - Hot dipped galvanised	•	•	•
Furniture - Euro style with aluminium corners & seat framing	•	•	•
Roof - sandwich construction, one piece fibreglass skin	•	•	•
Suspension - JTECH 2.0 suspension independent coil including raiser providing 50mm lift	•	•	-
Suspension - JTECH AIR independent Air Bag suspension including raiser providing 50mm lift	◦	◦	•
Heavy duty shock absorbers	•	•	•
Walls - one piece composite fibreglass internal & ceiling	•	•	•
Fibreglass Exterior - Dune Walls - fully insulated Toughframe, hail & dent resistant	•	•	◦
Fibreglass Exterior - Grey Walls - fully insulated Toughframe, hail & dent resistant	◦	◦	•
Floor - One Piece Polyethylene Terephthalate (PET)	•	•	•

SAFETY

Tow secure emergency braking system [^]	•	•	•
Sway Command Tow Control	•	•	•
ABS braking	-	◦	◦
Child restraints to bunk area [^]	•	•	•
Electric brakes	•	•	•
Main door with integrated mesh screen & multiple security locks	•	•	•
Reversing Camera Single Wireless	•	•	-
Reversing Camera Dual Wireless	◦	◦	•
Tyre pressure monitoring (48v Pack only)	◦	◦	•

STORAGE

EziGlide drawers	•	•	•
Large storage area under bed	•	•	•
Overhead storage compartments	•	•	•
Bumper bar mounted firewood rack	-	-	•
Side entry boot including ABS boot liner	•	•	•
Slide out heavy duty storage tub to tunnel boot [^]	◦	◦	◦
Slide out heavy duty storage tray to tunnel boot [^]	◦	◦	◦

• Standard ◦ Optional - Not Available [^] Model Specific

TECHNOLOGY

	ADVENTURER 48V		
	CROSSTRAK CARAVAN		
	CROSSTRAK POP TOP		
Battery - 300Ah Lithium	•	•	-
Battery - Lithium 5.05kw under chassis mount battery (48V Power System Pack required)	◦	◦	•
Battery - 2x Lithium 5.05kw under chassis mount battery (48V Power System Pack required)	-	-	◦
Bedlights incorporating USB ports	•	•	•
Bluetooth gas bottle sensor including phone App	•	•	•
CD/Radio with internal & external speakers [^]	•	•	•
Fixed Roof mounted TV antenna	•	•	•
Portable speaker & dock	◦	◦	•
Power - 3000W Inverter	•	•	-
Power - 48V System with 4000W inverter (48V Power System Pack required)	◦	◦	•
Power - External Anderson plug solar input to offside	•	•	•
Power - PM535J -35amp AC Charger, Integrated 30amp DC/DC Charger, MPPT Solar Charging & Bluetooth App monitoring	•	•	-
Power - Strategically placed USB & USB C ports	•	•	•
Solar - 2x 260W solar panels with twin cell technology & regulator	•	-	-
Solar - 4x 260W solar panels with twin cell technology & regulator [^]	-	•	•
Solar - 5x 260W solar panels with twin cell technology & regulator [^] (transitioning across to 5, currently only certain models have them)	-	-	•
Starlink Mini Ready - (offside 100w Power Socket & 12v water proof lead)	•	•	•
Touch Screen - 10-inch touch screen panel for monitoring vital RV system status, including battery and water levels.	-	-	•
Touch Screen - 4-inch LCD touch screen panel for monitoring vital RV system status, including battery and water levels.	•	•	-
TV - 27" 12v Smart TV including Soundbar	◦	◦	•

INTERIOR

Cooktop - 2-Burner internal	•	•	-
Cooktop - Induction dual cooktop internal & external (48V Power System Pack required)	◦	◦	-
Cooktop - Induction dual cooktop with convection Microwave.	-	-	•
Fridge - 60L 12V Slide out fridge/freezer	◦	◦	-
Fridge - 153L 12V Dual Hinge fridge with built in freezer compartment	•	•	-
Fridge - 224L 12V fridge with separate freezer drawer compartment	-	-	•
Premium doona and pillows	•	•	•
Queen Slumberest Premium Cloud 9 Pillowtop Mattress (Queen - Island beds only)	•	•	-
Queen Luxury Tempur Mattress (Queen - Island beds only)	◦	◦	•

INTERIOR

	ADVENTURER 48V		
	CROSSTRAK CARAVAN		
	CROSSTRAK POP TOP		
Rangehood with 12V LED light & twin fans^	•	•	•
Roof mounted air conditioner	•	•	-
Roof mounted air conditioner - Freshjet series 7 Lite 48V (48V Power System Pack required)	◦	◦	•
Seating area with selection of durable leatherette	•	•	•
Seating area with selection of genuine European leather	◦	◦	◦
Modern design shower with exhaust fan	•	•	•
12V fan to main bed 2x	•	•	•
12V fan to bunks (bunk models only)	-	-	◦
12V fan to dinette area	-	-	•
On-Demand Gas hot water system	•	•	•
Ducted diesel heating^	◦	◦	•
Top load washing machine with 3.3kg capacity^	◦	◦	•
Slide-out pantry	•	•	•
Swivel Table Leg	•	•	-
Square Gunmetal Sink	•	•	-
Square Champagne Sink	-	-	•
Water filtration system to sink (Internal sink in Crosstraks)	◦	◦	•

EXTERIOR

Power - 12V Power socket doorside	•	•	-
Power - 240V power outlet doorside	-	-	•
Power - Dual 240V power outlets doorside	•	•	•
Alloys & Tyres - 245/70R16 AT including spare	•	•	•
Alloys & Tyres - 265/65R17 AT including spare	◦	◦	◦
Awning walls	-	-	◦
Corner steadies - Drop	•	•	•
Coupling - Cruisemaster D035	•	•	•
Dust Reduction System	•	•	•
Awning - 12V electric roll out awning including LED strip light	-	•	•
Awning - Manual Rollout awning	•	-	-
Extended A-frame	•	•	•
External shower	•	•	•
External pressure fill plumbing console	•	•	•
Light - External Switch Annexe Light above trunk doors & door side	•	•	•

EXTERIOR

	ADVENTURER 48V		
	CROSSTRAK CARAVAN		
	CROSSTRAK POP TOP		
Light - Single door side sensor annexe light	•	•	•
Light - Dual door side sensor annexe lights to suit 21'units & above	-	-	•
Water tank - Fresh 2 x 75L	•	•	-
Water tank - Fresh 2 x 95L	-	-	•
Water tank - Grey water tank	•	•	•
Front tool box - Extra large with top and side access storage doors, side storage wings and gas bottle cover.	•	•	•
Gas bottles - 2 x 9kg	•	•	•
Powered 12v Centre A-frame jack + A-frame Side mount jockey wheel clamp	•	•	•
Light - Grab handle with integrated 12V LED light	•	•	•
Light - LED 12V side	•	•	•
Light - LED 12V Amber/White strip light above external kitchen	•	•	•
Light - LED Lightbar Front & Rear	•	•	•
Light - LED under chassis rock lights including phone App	•	•	•
External offside front mains pressure tap	•	•	•
Mudflaps	•	•	•
Nitrogen filled tyres	•	•	-
Picnic table including storage	•	•	•
Rear departure angle including skid plates	•	•	-
Rear bumper bar including storage & dual jerrycan holders	•	•	-
Rear bumper bar including storage drawer, storage boxes & dual jerrycan holders	-	-	•
Rear bumper bar including storage drawer, Dual spare wheels & dual jerrycan holders	-	-	◦
Side checkerplate protection	•	•	•
Side Chassis mount Brushbars	◦	◦	◦
Slide out external kitchen with 2 burner cook top and sink	•	•	-
Slide out external kitchen with induction cook top and sink (48V Power System Pack required)	◦	◦	◦
Slide out external fridge slide	•	•	-
Stoneguard to A-frame	•	•	•
Aluminium Pull out step - Manual	•	•	-
Aluminium Pull out step - Powered^	-	-	•
Under body protection flap	•	•	•
Bayonet - Dual Side mount under chassis gas bayonet for external cooking	•	•	•

BASESTATION

TOY HAULER

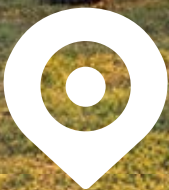

**WORK HARD. PLAY HARDER.
TRAVEL YOUR WAY!**

There's freedom in bringing everything with you.

The MY26 Jayco Basestation is built for travellers who want space, strength and flexibility — without giving up comfort.

Designed as a true toy hauler, Basestation pairs a dedicated rear garage with genuine caravan living. Load up your bikes, tools or adventure gear, then settle into a well-appointed interior built for longer stays.

With serious lithium capacity, integrated charging, high-output solar and intelligent climate control, Basestation delivers the power and practicality to work hard, play harder and travel your way.

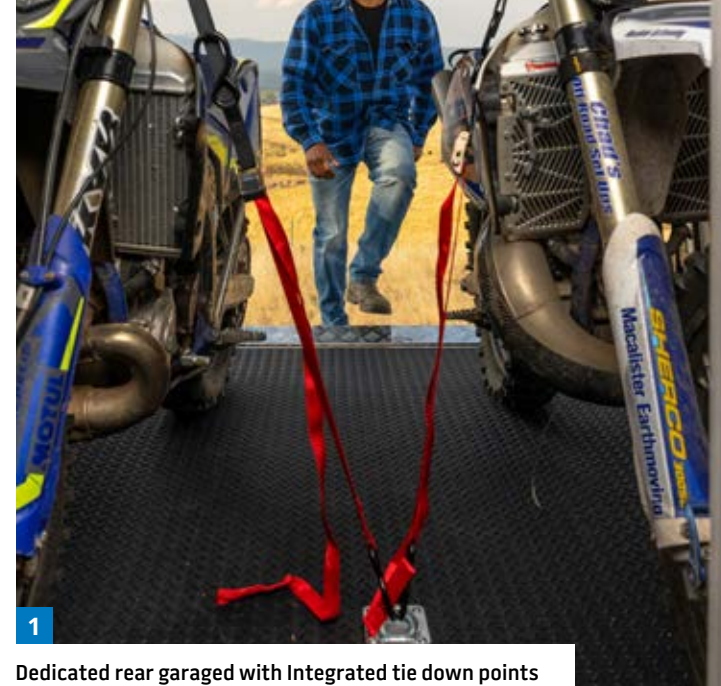

Dedicated rear garage with integrated tie down points

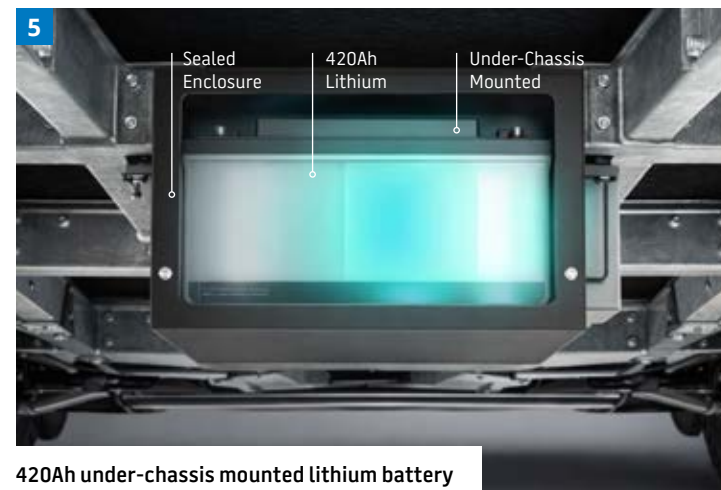

420Ah under-chassis mounted lithium battery



MADE FOR LIFE IN MOTION

1. Dedicated Rear Garage Space

Dedicated rear garage with integrated tie-down points converts to additional living space when unloaded.

2. Premium Sleeping Comfort

Queen Luxury Tempur® mattress, high-density bunk mattresses, premium bedding and climate control for year-round comfort.

3. Smart Climate & Control

10-inch touchscreen monitors battery and water levels, paired with ducted diesel heating and roof-mounted air conditioning.

4. Intuitive System Control

224L 12V fridge with separate freezer drawer, 4-burner cooktop with oven, microwave and generous overhead storage.

5. Serious Power Capability

420Ah under-chassis lithium battery, 4 x 260W twin-cell solar panels and integrated AC/DC charging.



Rear garage converts into comfortable living area



Queen Luxury Tempur® mattress



224L 12V fridge with separate freezer drawer



10" LCD touchscreen panel

FEATURES

• Standard ◦ Optional - Not Available ^ Model Specific

CONSTRUCTION

	BASESTATION TOY HAULER	BS	4T
Chassis - Hot dipped galvanised	•	•	
Extended reinforced A-frame including heavy duty safety chains	-	•	
Furniture - Euro style with aluminium corners & seat framing	•	•	
Roof - sandwich construction, one piece fibreglass skin	•	•	
Suspension - JTECH 2.0 suspension independent coil including raiser providing 50mm lift	•	•	
Suspension - JTECH AIR independent Air Bag suspension	◦	◦	
Heavy duty shock absorbers	•	•	
Walls - fully insulated Toughframe, hail & dent resistant	•	•	
Walls - one piece Italian fibreglass internal & ceiling	•	•	
Floor - One Piece Polyethylene Terephthalate (PET)	•	•	
Fibreglass Exterior - Grey Walls - fully insulated Toughframe, hail & dent resistant	•	•	
Fibreglass Exterior - Dune Walls - fully insulated Toughframe, hail & dent resistant	◦	◦	

SAFETY

Tow secure emergency braking system^	•	•	
Sway Command Tow Control	•	•	
ABS braking	•	•	
External triple lock security main door	•	•	
Reversing Camera Dual Wireless	•	•	
Electric brakes	•	•	

STORAGE

Ezi-Glide drawers including pot drawer	•	•	
Overhead storage compartment	•	•	
Rear tie down points to garage	•	•	
Dual Side access tunnel boot	•	•	
Slide out heavy duty storage drawer	◦	◦	
Slide out heavy duty storage tub to tunnel boot	◦	◦	

TECHNOLOGY

	BASESTATION TOY HAULER	BS	4T
Battery - Lithium 420Ah under chassis mount battery	•	•	
TV - 27" Smart TV including Soundbar	•	•	
Power - PM635J -60amp AC Charger, Integrated 45amp DC/DC Charger, MPPT Solar Charging & Bluetooth App monitoring	•	•	
Bluetooth gas bottle sensor including phone App	•	•	
CD/Radio with internal & external Speakers	•	•	
Power - External Anderson plug solar input to offside	•	•	
Touch Screen - 10-inch touch screen panel for monitoring vital RV system status, including battery and water levels.	•	•	
Solar - 4x 260w twin cell solar panels*	•	•	
Solar - 5x 260w twin cell solar panels*	◦	◦	
Power Pack - Off Grid Power Pack - 3000W Inverter*	◦	◦	
Fixed Roof mounted TV antenna	•	•	
Portable speaker & dock	◦	◦	
Satellite TV System*	◦	◦	
Starlink Mini Power Socket - (offside 100w Power Socket & 12v water proof lead)	•	•	
Power - Strategically placed USB & USB C ports	•	•	
Slide out heavy duty storage tub to tunnel boot	◦	◦	

INTERIOR

Fridge - 224l 12v fridge with separate freezer drawer compartment	•	•	
Cooktop - 4-burner cooktop with built in griller/oven	•	•	
On demand gas hot water system	•	•	
Ducted diesel heating^	•	•	
High density foam mattresses to bunk areas	•	•	
Queen luxury tempur mattress	•	•	

INTERIOR

	BASESTATION TOY HAULER	BS	4T
Microwave	•	•	
Modern design shower with exhaust fan	•	•	
12v fans - x 2	•	•	
12v Fan to Dinette Area (24.75-6 only)	-	•	
Premium doona and pillows	•	•	
Rangehood with 12v LED light & twin fans	•	•	
Rear pull down flyscreen blind	•	•	
Roof mounted air conditioner	•	•	
Roof mounted air conditioner to garage area (N/A 48v Pack)	-	◦	
Seating area with selection of modern fabrics (19.61-7 only)	•	-	
Seating area with selection of durable leatherette (24.75-6 only)	•	•	
Seating area with selection of genuine European leather (24.75-6 only)	◦	◦	
Shurflo 12v water pump	•	•	
Top load washing machine with 3.3kg capacity (24.75-6 Only)	◦	◦	
Water filtration system to sink	•	•	

	BASESTATION TOY HAULER	BS	4T
Power - 12V Power socket doorside	•	•	
Awning - 12V electric roll out awning including LED strip light	•	•	
Power - 240V power outlet doorside	•	•	
Alloys & Tyres - 245/70R16 AT including spare	•	-	
Alloys & Tyres - 245/75R16 AT including spare	-	•	
Corner steadies - Drop	•	•	
Coupling - Cruisemaster D035	•	-	
Coupling - Cruisemaster D045	-	•	
Dust Reduction System	•	•	
Extended A-frame	•	•	
External entertainment hatch including swivel TV bracket	•	•	
External shower	•	•	
External pressure fill plumbing console	•	•	
Light - External Switch Annexe Light above truck doors & door side	•	•	

BS: Standard

4T: 4 Tonne upgrade

BASESTATION

FLOOR PLANS

L Travel Length W Travel Width H Travel Height

T Tare Weight B Towball Weight

 Shower
  Refrigerator
  Wardrobe

INTERIOR

BASESTATION TOY HAULER

BS

4T

Light - External Switch Annex Light above external shower	•	•
Fresh water tank - 2 x 95L	•	•
Front tool box - Extra large with top and side access storage doors, side storage wings and gas bottle cover	•	•
Gas bottles - 2 x 9kg	•	•
Grey water tank	•	•
Powered 12v Centre A-frame jack + A-frame Side mount jockey wheel clamp	•	•
Light - LED 12v doorside	•	•
Light - LED 12v grab handle	•	•
Light - LED Light bar at front & Dual Lights to the Rear	•	•
Light - LED under chassis rock lights including phone App	•	•
External offside front mains pressure tap	•	•
Mudflaps	•	•
Nitrogen filled tyres	•	•
Picnic table including storage	•	•
Side checkerplate protection	•	•
Slide out external kitchen with 2 burner cook top and sink	◦	◦
Stoneguard to A-frame	•	•
Aluminium Pull out step - Powered	•	•
Bayonet - Dual Side mount under chassis gas bayonet for external cooking	•	•

48V POWER UPGRADE OPTIONS

Power - 48V System with 4000W inverter	◦	◦
Battery - Lithium 5.05kw under chassis mount battery	◦	◦
Battery - 2x Lithium 5.05kw under chassis mount battery	◦	◦
Cooktop - induction dual cooktop with convection microwave	◦	◦
Slide out external kitchen with induction cook top and sink	◦	◦
Tyre pressure monitoring	◦	◦

FAMILY MODEL

19.61-7

Tandem Axle



	BS
L	8210 mm
W	2460 mm
H	3040 mm
T	2609 kg
B	307 kg

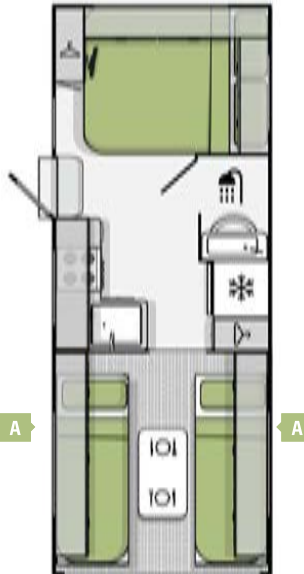

FAMILY MODEL

24.75-6

Tandem Axle



	BS	4T
L	9680 mm	9680 mm
W	2460 mm	2460 mm
H	3040 mm	3040 mm
T	2960 kg	3085 kg
B	293 kg	327 kg

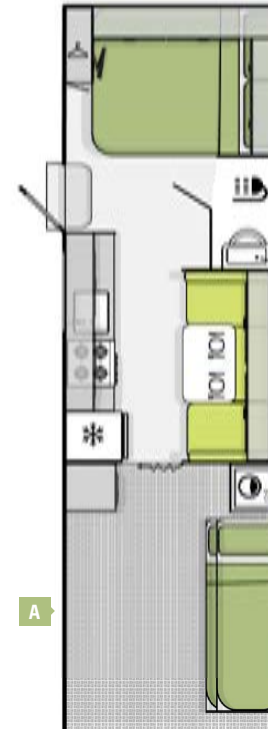

MAKE IT YOUR WAY

Optional modules available

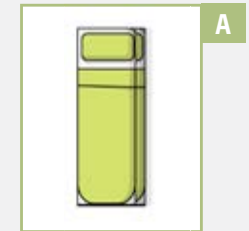

Double bunks

MAKE IT YOUR OWN

Bring your basestation to life with Jayco's Build & Price tool.



The weights and dimensional data are not binding. Jayco reserves the right to alter specifications without notice. These are a guide only and will change depending on the accessories fitted to your van. It is advised to discuss this with your Jayco representative. The load carrying capacity of Jayco RVs vary from product to product to ensure it is fit-for-purpose.

OPTIONAL FEATURES

MADE YOUR WAY

Your Jayco should reflect how you travel. That's why we offer a range of optional features designed to enhance comfort, capability and convenience — so you can tailor your caravan to suit your lifestyle and the way you like to explore. Whether it's adding practical storage, upgrading your power system or enhancing off-grid capability, these options let you go further, stay longer and feel even more at home on the road.

Visit your local Jayco dealer to explore the full range of optional features and find the setup that's made for you.



^Available on selected models only. All images are for illustration purposes only. Appearance subject to change.



Slide-out kitchen with gas or induction cooktop^



Slide out heavy duty storage tray to tunnel boot^



Top load washing machine with 3.3kg capacity^



Air bag suspension^

48V POWER SYSTEM UPGRADE PACK

Stay powered off-grid for longer with advanced solar charging, efficient battery management, and real-time monitoring—giving you the freedom to explore further without compromise.

4000W Inverter

PM535J - 120amp AC charger

Integrated 30amp DC/DC charger

MPPT solar charging

Bluetooth app monitoring

5.05kW Battery

5x 260w Twin Cell Solar Panels

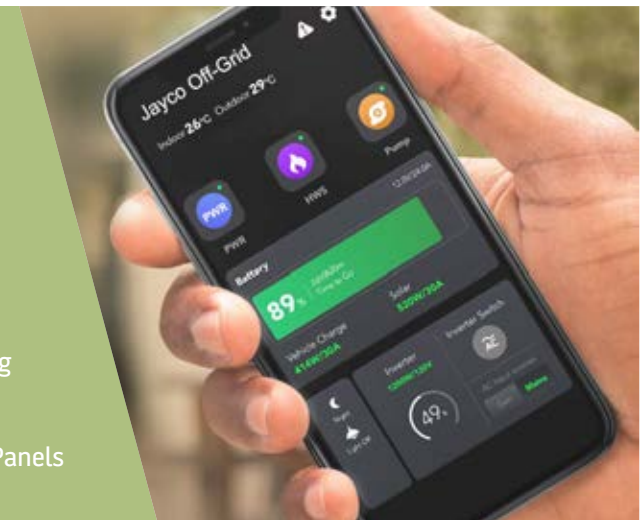

QUALITY CONSTRUCTION

MADE FOR THE LONG JOURNEY

Jayco are built using advanced materials and proven construction methods — not to impress on paper, but to perform where it matters. Designed for Australian conditions and real-world travel, every detail is made to deliver lasting strength, everyday comfort and confidence over years of ownership — not just the first trip.



1. COMPOSITE WALL & ROOF SYSTEM

Vacuum-bonded composite walls and a one-piece domed roof improve insulation, reduce noise and enhance durability.

2. ALUMINIUM FRAME CONSTRUCTION

An aluminium frame — not timber — provides increased structural strength with reduced weight, supporting confident towing and long-term reliability.

3. INSULATED COMPOSITE WALL CORE

High-density insulation within the composite wall system improves thermal performance and interior comfort.

4. ONE-PIECE COMPOSITE FLOORING

Rot-resistant composite flooring delivers long-lasting durability and improved thermal insulation.‡

5. HOT DIPPED GALVANISED ENDURANCE CHASSIS

Each chassis is hot dipped galvanised inside and out, delivering superior corrosion resistance, strength and reduced maintenance over time.

6. JTECH 2.0 INDEPENDENT SUSPENSION*

Jayco's JTECH 2.0 suspension system enhances stability, handling and ride comfort, helping deliver smoother, more predictable towing.



EUROSTYLE FURNITURE

Unique to Jayco is the aluminium furniture construction which consists of aluminium extrusions incorporated into the furniture framing to increase strength and durability.



* Available on Outback models only. ‡ N/A Starcraft

MADE FOR CONFIDENCE. LONG AFTER THE BUILD.

Buying an RV is a big decision — and confidence matters well beyond the first trip. From how your Jayco is built, to how it's supported years down the track, everything is designed to deliver lasting value, reliability and peace of mind at every stage of ownership. Because being made for here isn't just about where your journey starts — it's about knowing you're backed wherever it leads.

BUILT HERE. BACKED FOR THE LONG HAUL.

Proudly designed and built in Australia for over 50 years, Jayco caravans are engineered using quality materials and local expertise to suit Australian conditions. Just as importantly, they're supported long after you leave the showroom — so you can travel with confidence today, and for years to come.

MORE INCLUDED. FEWER COMPROMISES.

Jayco caravans come equipped with features many brands list as optional extras. That means better value from day one, fewer surprises, and a setup that's ready to go when you are — without needing to add more just to get started.

PARTS, ACCESSORIES & PEACE OF MIND.

With one of the largest parts and accessories networks in Australia and New Zealand, Jayco makes it easy to service, maintain and personalise your caravan over time. From routine maintenance to upgrades down the track, ownership is simple, supported and stress-free.

STRONG RESALE. SMARTER INVESTMENT.

Built with quality and long-term reliability in mind, Jayco caravans hold their value exceptionally well. It's an investment that delivers enjoyment now — and confidence when it's time to upgrade.

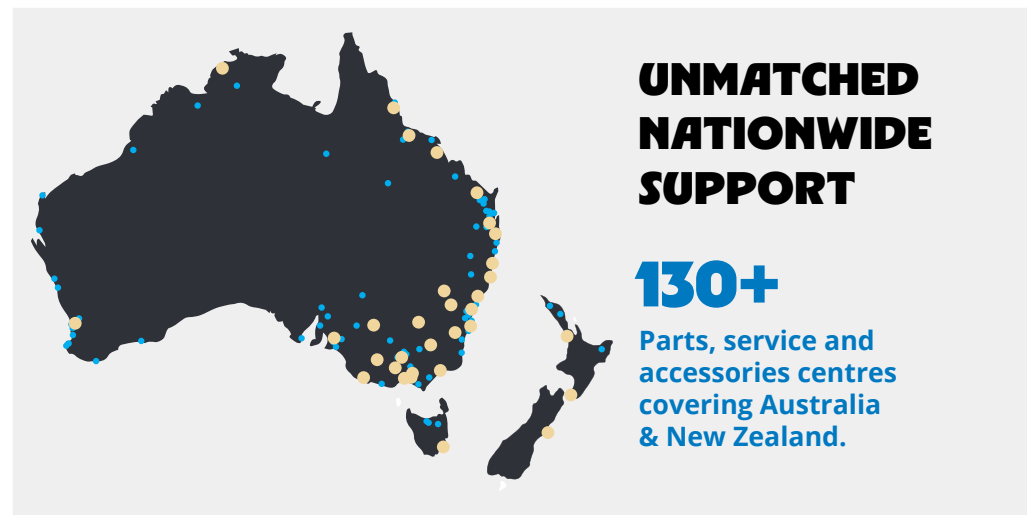



FINANCE THE DREAM.

FAST, SIMPLE RV FINANCE, TAILORED TO YOU — WITH JAYCO FINANCIAL SERVICES.



Competitive rates and products



Flexible terms from 1-7 years



No obligation quotes



Wide range of products



Quick and easy approval



SCAN FOR MORE INFORMATION

JAYCO PLATINUM INSURANCE

JAYCO PLATINUM INSURANCE IS DESIGNED TO MAKE OWNERSHIP SIMPLE AND STRESS-FREE.

With a fast, straightforward claims process, repairs carried out using Jayco Genuine Parts, and a lifetime warranty on workmanship for approved repairs, you can travel with added confidence. Coverage, terms and conditions apply. Ask your Jayco dealer for full policy details to ensure the cover is right for you.



Fast, easy claim process



Jayco Genuine Parts



Lifetime warranty on workmanship



Jayco Approved Repairers



Insurance Confidence



RELAX. YOU'RE IN A JAYCO.

Jayco's comprehensive warranty promise offers 2 years manufacturing and 5 years structural warranty coverage. Our warranty provides added peace of mind for our travelling customers. All warranty repairs are managed by our extensive reach of dealerships and authorised service agents who have direct access to Jayco's knowledge bank and systems for warranty repairs and delivery of parts.



HERE FOR YOU ON YOUR JOURNEY

Jayco RV owners can enjoy the reassurance of the Jayco Assist program available with every purchase of a new Jayco RV* to the original owner. Jayco Assist provides 24/7 emergency support and assistance for the first three years of Jayco RV ownership whilst travelling and away from home.

Jayco Financial Services Pty Ltd Credit Representative number 513573 of My Local Broker PTY LTD (Australia Credit License no 481374) Finance will be supplied to approved applicants only (not available to fleet, government or rental buyers), subject to credit assessment and lending criteria. Fees and charges are payable. Full conditions available on application.

* RVs used for commercial use are not covered by the Jayco Assist. Jayco RVs in New Zealand are not covered under Jayco Assist. New Zealand Jayco RV owners are recommended to seek an independent emergency assist program.



MADE FOR HERE

JAYCO.COM.AU | 1300 JAYCO RV

OUR RVs ARE BUILT WITH ONLY THE BEST QUALITY COMPONENTS SOURCED FROM AROUND THE WORLD



Jayco Corporation Pty Ltd owns the copyright in this brochure. Unauthorised use, reproduction or adaptation is forbidden and will be prosecuted.

Due to ongoing improvement, the specifications in this brochure are subject to change without notice.

©JAYCO 2026 PO Box 636 Dandenong VIC Australia 3175.