



MT HOTHAM Compact

SOFT TOP HYBRID CARAVAN WITH FOLD OUT BED & DUAL BUNK BEDS



Installed Internal fridge & Plenty of Bench Space



Interior bathroom with toilet & Shower for total convenience



Add on an inflatable annex to create an extra living space



The family sized hybrid caravan for families up to four who love to get outdoors!

One of the largest hybrids in our range, this big beast is ready to take on the outdoors. Fitted with independent suspension & running on dual tyres.

Featuring cooking facilities inside & out, a dining suite with footrests which converts into a bunk bed & on board installed fridge, camping in this hybrid is real luxury.

The a complete interior bathroom it puts everything you need close by.



ATM

Approx. 3500kg



Tare

Approx. 3000kg



Battery

3 x 12v AGM



Ball Weight

Approx. 300kg



Gas Bottle Holders

2 x 9kg



Jerry can Holders

2 x 20L



Lighting

LED strips



Stereo

Yes



Electric Brakes

12"



Water Tanks

1 x 80L
1 x 40L
1 x 80L Grey



Fridge Slide (cm)

L x W x H
98.5 x 47 x 66



Mattress Size

1 x Queen
2 x Single Bunks

MT HOTHAM Compact



Pop Top Hybrid Caravan



SPECIFICATIONS

Size closed (L) 7m (W) 2.35m (H) 2.5m

● Standard ○ Optional Upgrades

TRAILER

Tare 3000kg* Ball Weight 300kg*	●
Drawbar Tube Size 150mm x 50mm x 4mm	●
Hot Dip Galvanised	●
16" Mud Terrain Tyres	●
Alloy Tyre Rims	●
2 Spare Tyres Included	●
Independent Coil Suspension	●
Dual Shockers	●
12" Electric Brakes	●
Al-ko Jockey Wheel	●

KITCHEN & BATHROOM

Stainless Steel 3 Burner Cooktop with Lighting, Sink, Cutlery & Utility Drawer	●
Interior 4 Burner Cooktop & sink	●
Interior Mini Oven/Grill	●
Interior Installed Fridge	●
80L & 40L Water Tanks with bash plates	●
80L Grey Water Tank with bash plate	●
Stainless Steel Taps with Hot & Cold Function	●
Installed On Board Hot Water Unit	●
Thetford Cassette Toilet	●
Gas Connection to Cooker	●
External Shower Outlet & Ensuite Tent	●
Fold Down Side Serving Bench	●

POWER

Anderson Plug Connection for Car	●
3 x 12V AGM Century Branded Batteries	●
Control Panel with Voltmeter & Water Gauge	●
Multiple 12V Sockets with Dedicated Fridge Socket	●
240V Connection	●
Inverter Charger System	●

STORAGE

6 x External Storage Compartments Including dedicated fridge slide	●
12 x Internal Storage Drawers Plus under Seat & Bed Space	●
2 x 9kg Gas Bottle Holders	●
2 x 20L Jerry Can Holders	●
Massive front Toolbox	●

EXTERIOR GENERAL

Fibreglass body	●
Lumberjack Style Mudflaps	●
Trailer Plug to suit Vehicle	●
Checker Plate Stone Guard	●
Electric Sunshade Awning	●
Heavy Duty Swing Out Steps	●
Doors with Detachable Separate Screen Door	●

INTERIOR GENERAL

Multimedia System (CD, MP3, BT, SD, USB & DVD)	●
Internal LED Light Strips plus step light & External LED Lights	●
Queen Sized Main Bed	●
Single Bunk Bed with Collapsible Guard Rail	●
Convertible Dining Suite to Single Bed	●
LCD/LED 17" Monitor	●
Dual Interior & Exterior Speakers	●
PU Leatherette Seating	●
Fold Down Footrests on Dining Suite	●
Fold Down Table Included	●
Wood Printed Vinyl Flooring	●
Built in Windows with Block out & Flyscreen Panels	●

SAFETY

Fire Extinguisher Included	●
High Strength Recovery Points at rear	●
ADR Approved Safety Chains & Coupling	●
Victorian Standard Break Away System	●

OPTIONAL UPGRADES

Extra Gas Bayonette Fitting	○
Extra 240V Outlet Points	○
Installed Air Conditioning Unit	○
Roof Mounted Solar Panels	○
Inflatable Wrap Around Annex	○
Installed Diesel Heater	○

CAMPING ACCESSORIES

95L Dual Zone Fridge Freezer	○
2KVA Generator	○
Portable Camping Toilet	○
160w Portable Solar Panels	○

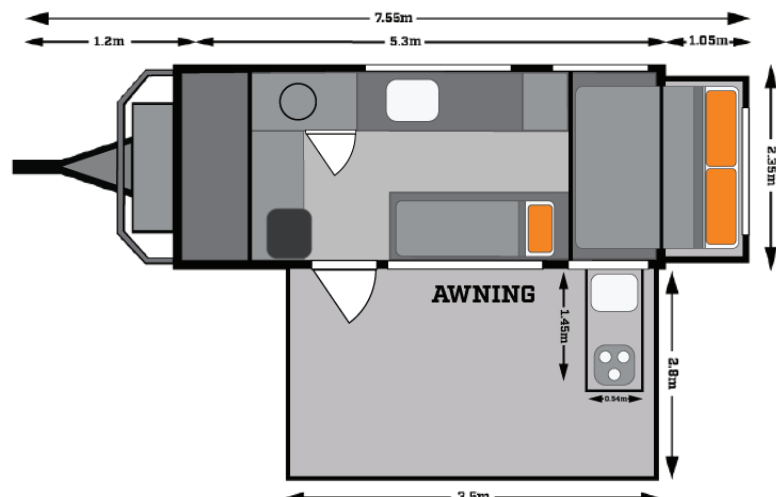

* Data accurate at time of print, check online for most current information.